

## A.C. Meter Packages

### 1-Phase, AC Meter Panel Kit# 1222

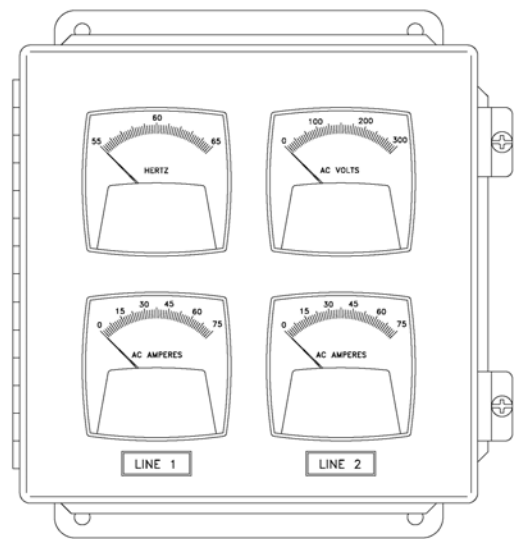

**Includes:** Voltmeter, (2) ammeters, current transformers (loose) and frequency meter. Wired to terminal strip for connection to main leads in electrical locker.  
**Enclosure:** 8x8x4" NEMA12 w/ hinged cover. Shipped loose. Dwg# 11573

#### System Features:

- ◆ Voltmeter
- ◆ (2) Ammeters w/ current transformers
- ◆ Frequency Meter

### 3-Phase, AC Meter Panel Kit# 1223

**Includes:** Voltmeter, ammeter, current transformers (loose), 3-phase selector switch and frequency meter. Wired to terminal strip for connection to main leads in electrical locker.  
**Enclosure:** 8x8x4" NEMA12 w/ hinged cover. Shipped loose. Dwg# 11574

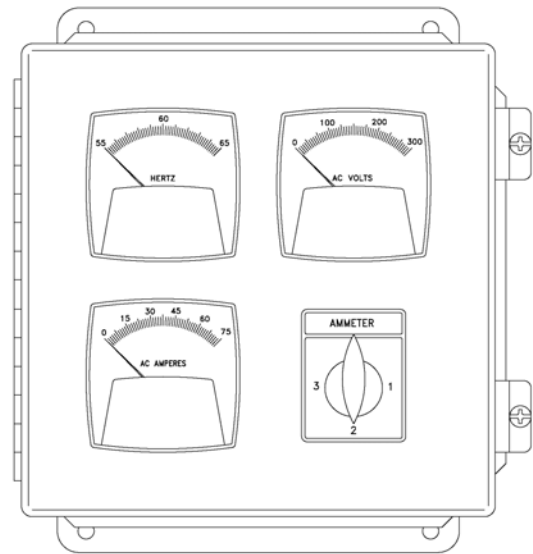

#### System Features:

- ◆ Voltmeter
- ◆ Ammeter w/ current transformers
- ◆ 3-phase selector switch
- ◆ Frequency Meter

#### - More Options-

**AC Ammeter Panel, 3-phase, Kit#1249** Includes: Ammeter, (3) current transformers (loose) and 3-phase selector switch. Wired to terminal strip for connection to main leads in electrical locker. **Enclosure:** 8x8x4" NEMA12 w/ hinged cover for wall mounting. Shipped loose. Dwg# 11762

**Optional AC current overload protection system Kit#1576:** Fully adjustable 3-phase monitoring of AC current provides user adjustable protection against short circuits and nonlinear (unequal) phase loading, and/or generator phase overloading. All control functions wired to terminal block. Customer provides interconnect wiring to remote panel. Resettable from Remote Control Panel.

1. **CAUTION:** This system **does not** break the circuit between the generator and the load cables; protection from residual current flows or protection from HEP back-feed requires installation of a line circuit breaker.

## Stadco Railgen™ Control Systems

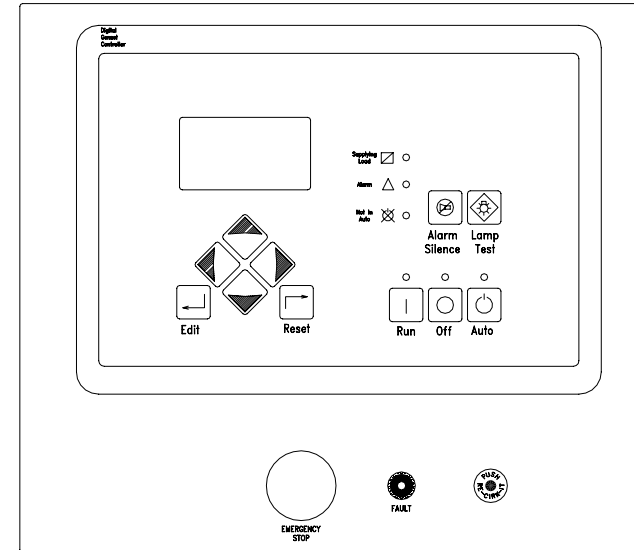

Remote Panel: 14.0"W x 12.0"H



Unit Mounted Panel: 10.3"W x 8.3"H

#### System Features:

- ◆ Automatic Start/Stop Functionality
- ◆ Engine Metering
- ◆ Engine Fault Protection
- ◆ Event Recording
- ◆ AC Generator Metering
- ◆ Generator Protection
- ◆ Priority Emergency Stop Switch
- ◆ J1939 CANBUS or Analog Sender Capable
- ◆ Input & Output Programmable w/Controller or PC
- ◆ Enclosure Heat Sensing System

### Mark 5, System #1665 Type D-2 Digital Control System

**Includes:** Interconnected dual controls via; (1) Unit mounted control panel and (1) Remote panel (shipped loose). Remote Panel equipped w/digital genset controller which is a highly advanced integrated genset control system. This device provides genset control, automatic transfer switch control, AC metering, protection and programmable logic in a simple easy to use reliable, rugged system. Starter operation is fully automatic to prevent starter overcranking and accidental re-engagements. Front panel and PC Programmability, J1939 CANBUS Communications, Input and Output programmable logic to easily customize the controller. Enclosure heat sensing system installed on all Mark 5 generators.

#### Engine and Generator protection:

**DC Engine control features:** Automatic start, cooldown and engine stop operation capable. Engine metering of oil pressure, engine temperature, RPM, Battery Voltage and hourmeter. Engine fault protection system with Pre-Alarm and shutdown capability. Event recording upon fault shutdown. Generator metering of amps, Hertz, current, watts and power factor. Generator protection over and under voltage, over and under frequency capable. J1939 Canbus or analog Sender capable. Input and Output Programmable using front panel or PC to meet specific needs. Priority "Emergency" stop switch. **Alarm Indicator (Red) LED** - Continuous during alarm conditions and flashes during pre-alarm conditions. **Supplying Load Indicator (Green) LED** - Continuous when generator current is greater than EPS threshold current. **Auto Mode Indicator (Green) LED** - Continuous when Run mode is Auto. **Off Mode Indicator (Red) LED** - Continuous when controller is in OFF mode.

Stadco Railgen™ Control systems are factory wired, installed & tested. Remote panels are prewired and shipped loose. Standard control interface wiring included - wired to unit distribution box. **Load Circuit Breaker not included.**

**WARNING:** This control system does not provide absolute protection against major equipment damage in the event of abnormal operating conditions. Maintain and test this system per instructions in corresponding Stadco Operators Manual.

Visit us online: [www.stadcogen.com](http://www.stadcogen.com)

Some items shown may be optional equipment or may vary dependent upon model.

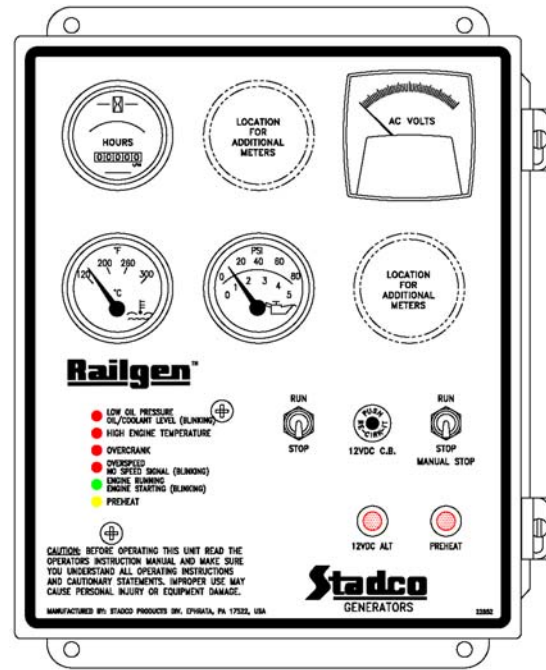

Remote Panel: 11.0"W x 13.5"H

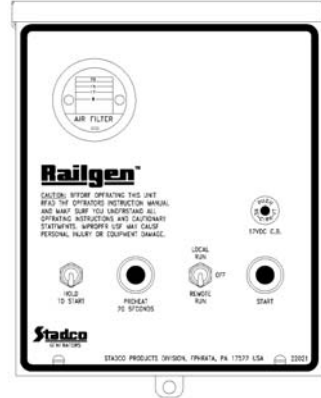

Unit Mounted Panel: 10.3"W x 8.3"H

### System Features:

- ◆ 8-Point engine protection system
  - Oil Pressure
  - Oil Level
  - Oil Temperature
  - Engine Temperature
  - Coolant Level
  - Overspeed
  - Overcrank
  - Starter Lockout
- ◆ Fault indicator lamps
- ◆ Micro-processor engine controller w/ autocrank starting
- ◆ Toggle switch start/stop operation
- ◆ Priority emergency stop switch
- ◆ Enclosure Heat Sensing System

## Mark 5, System # 1573 Type B-2 Micro-Processor Controlled w/Analog Displays

**Includes:** Interconnected dual controls via; (1) Unit mounted control panel and (1) Remote panel (shipped loose). Equipped w/ micro-processor engine controller which operates all control functions. Starter operation is fully automatic to prevent starter overcranking and accidental reengagements. Enclosure Heat sensing system installed on all Mark 5 generators. **8-point engine protection:** Oil pressure, Oil level, Oil temperature, Coolant temperature, Coolant level, Overspeed, Overcrank & Starter lockout. **DC Engine control features:** Master control switch, Hourmeter, Temp. gauge, Oil press. Gauge, Air cleaner service gauge, Manual emergency stop switch, Pre-heater controls & panel circuit breakers. Redundant RUN operating system on Unit Control Panel. Priority "Emergency" stop switch. **Pilot lamps for:** Engine started/Run signal, 12V. Alternator.  
**Failure indicator lamps for:** Low oil pressure, High engine temp, Overcrank, Overspeed, Engine started and Preheat.  
**AC control features:** AC power switch, voltmeter and panel fuses.

Stadco Railgen™ Control systems are factory wired, installed & tested. Remote panels are prewired and shipped loose. Standard control interface wiring included - wired to unit distribution box. **Load Circuit Breaker not included.**

**Custom & special purpose control systems:** Stadco offers custom design service for customers with special needs that are not met by the standard control system offerings.

**WARNING:** This control system does not provide absolute protection against major equipment damage in the event of abnormal operating conditions. Maintain and test this system per instructions in corresponding Stadco Operators Manual.

## Stadco HR Series Control System

Some items shown may be optional equipment

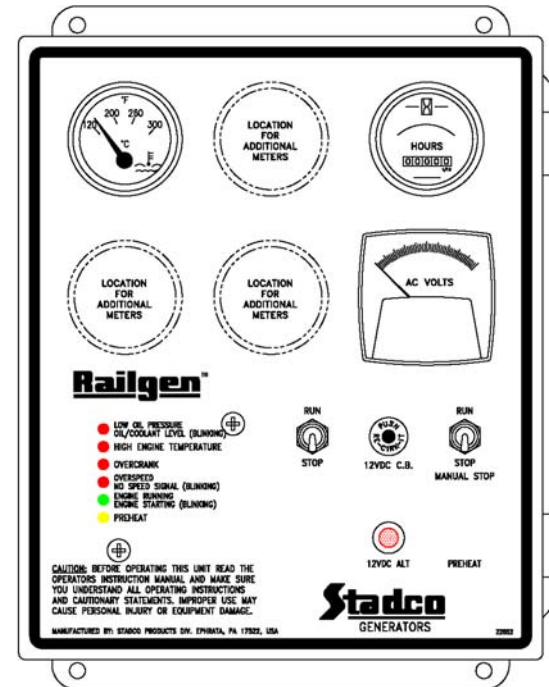

Remote Panel: 11.0"W x 13.5"H

### System Features:

- ◆ 5-Point engine protection system
  - Oil Pressure
  - Engine Temperature
  - Overspeed
  - Overcrank
  - Starter Lockout
- ◆ Fault indicator lamps
- ◆ Micro-processor engine controller w/ autocrank starting
- ◆ Toggle switch start/stop operation
- ◆ Priority emergency stop switch

## HR30/40/62 System #1575 Micro-Processor Controlled w/Analog Displays

**Includes:** Interconnected dual controls via; (1) Unit mounted control panel and (1) Remote panel (shipped loose). Equipped w/ micro-processor engine controller which operates all control functions. Starter operation is fully automatic to prevent starter over-cranking and accidental re-engagements.  
**5-point engine protection:** Oil pressure, Engine temperature, Overspeed, Overcrank & Starter lockout.  
**DC Engine control features:** Master control switch, Hourmeter, Temp. gauge, Manual emergency stop switch, Pre-heater controls & panel circuit breakers. Redundant RUN operating system on Unit Control Panel. Priority "Emergency" stop switch. **Pilot lamps for:** Engine started/Run signal, 12V. Alternator.  
**Failure indicator lamps for:** Low oil pressure, High engine temp, Overcrank, Overspeed, Engine started and Preheat.  
**AC control features:** AC power switch, voltmeter and panel fuses.

Stadco Railgen™ Control systems are factory wired, installed & tested. Remote panels are prewired and shipped loose. Standard control interface wiring included - wired to unit distribution box. **Load Circuit Breaker included w/HR Series.**

**WARNING:** This control system does not provide absolute protection against major equipment damage in the event of abnormal operating conditions. Maintain and test this system per instructions in the corresponding Stadco Operators Manual.